

The Modular Freestanding Office Furniture Planner includes...

Straight Worksurfaces

- 6" increments (from 24" to 72")
- 4 depths (20", 24", 30" & 36")
- Transition-Depth Surfaces

Corner Worksurfaces

- 5-sided corners
- 6-sided corners
- Extended corners

Conference Worksurfaces

- D - tops,
- P - tops,
- Q - tops
- D- Islands

Seating

- Executive
- Task
- Client
- Lounge

Storage

- Drawer Pedestals
- Storage Cabinets
- Wardrobes
- Overhead Storage
- Bookcases
- Under-Desk Storage

Filing

- Vertical Files
- Lateral Files
- Under-Desk Laterals

Misc. Items

- Meeting Tables
- Executive Desks
- Coat Racks
- Interior Plants
- Computer Equipment
- Fax Machines
- Drafting Table
- Photocopier
- Doors

The Board™ for modular office furniture is a must for anyone who plans with, sells, or moves & installs contract office furnishings.

With over 730 magnetic symbols on 4 pages it covers about 90% of the office furniture industry's most up-to-date & popular shapes and sizes. The scale is the industry-standard 1/4"=1' 0".

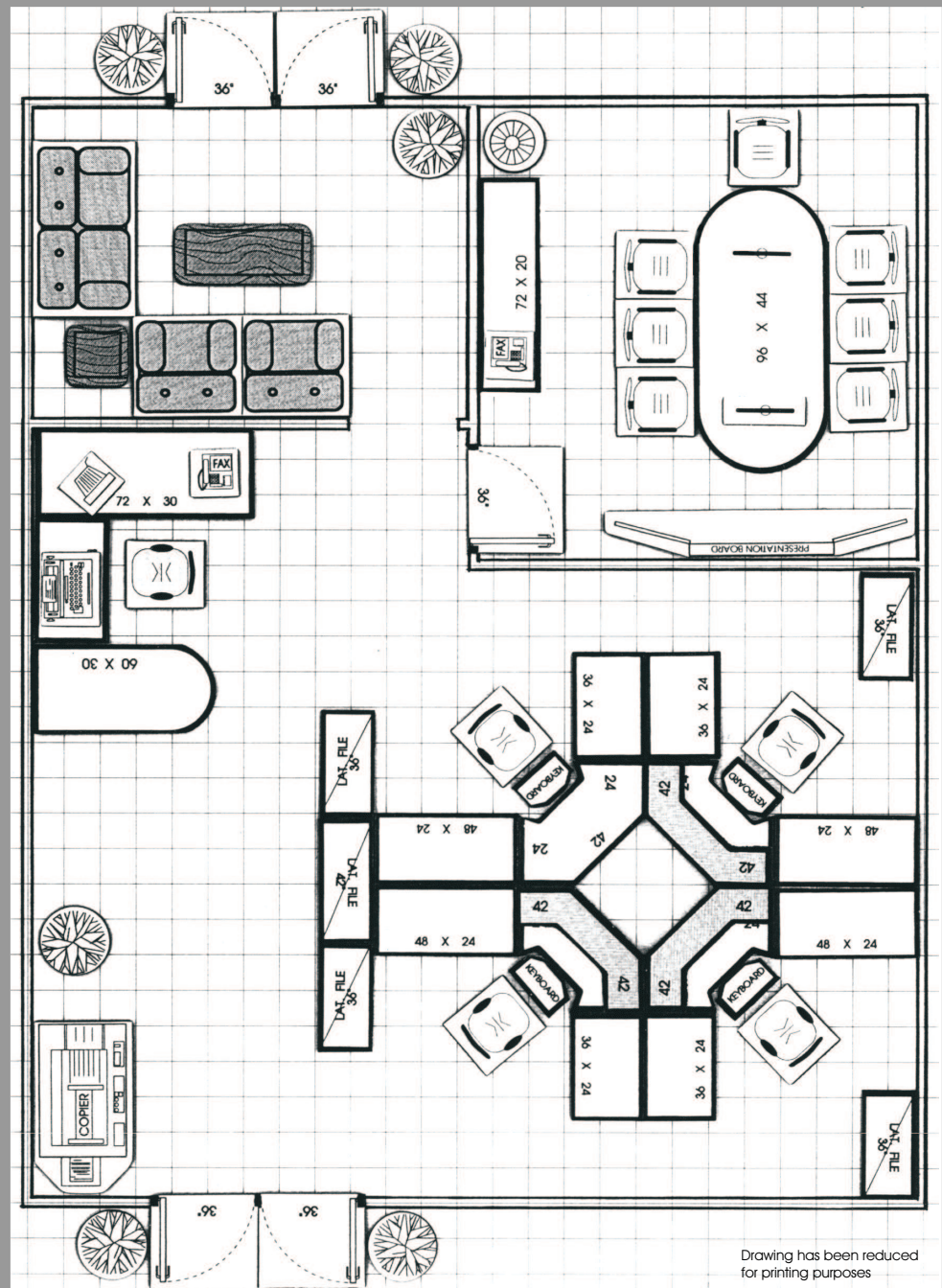

...almost everything you'd find in an office but people!

Drawing done using The Board™
Modular Office Furniture Planner (#MP-001)